

**ANTHONY**  
LIFTGATES, INC.®

**SM**

SM-1800  
SM-2500  
SM-3000

**OPERATION MANUAL**



**QUALITY, RELIABILITY, CUSTOMER SERVICE**

**MADE IN THE USA** 



# Contents

1. General Information . . . . .	3
1.1 Introduction . . . . .	3
1.2 Registration . . . . .	5
1.3 Customer Service and Parts . . . . .	5
1.4 Safety Signs (Decals) . . . . .	5
1.5 Warranty . . . . .	6
2. Safety Section . . . . .	6
2.1 Safety is Your Responsibility . . . . .	6
2.2 Safety Signal Words . . . . .	7
3. Operation Section . . . . .	7
3.1 General Operating Safety Instructions. . . . .	7
3.2 Operating Instructions . . . . .	9
4. Routine Service Items . . . . .	11
4.1 Check Power Module Fluid Level . . . . .	11
4.2 Power Cable Fuse - 200 Amp . . . . .	12
4.3 Control Switch Fuse - 10 Amp . . . . .	13
5. Replacement Safety Signs (Decals) . . . . .	13
5.1 Placement of Decals . . . . .	13
6. Troubleshooting . . . . .	22
7. Warranty Section . . . . .	25
7.1 Limited Warranty . . . . .	25
7.2 Warranty Policy and Procedure . . . . .	26

## 1. General Information

---

### 1.1 Introduction

Congratulations on selecting an Anthony Liftgates TuckUnder™ liftgate.

All Anthony tuckunder model liftgates are factory assembled, energized, and tested to ensure the highest quality performance standards.

To ensure your liftgate will perform to your expectations, we have provided this Operator Manual, which is designed to provide you with the necessary operating instructions and safety precautions for the operation of the Side Mount Tuckunder™ liftgate.

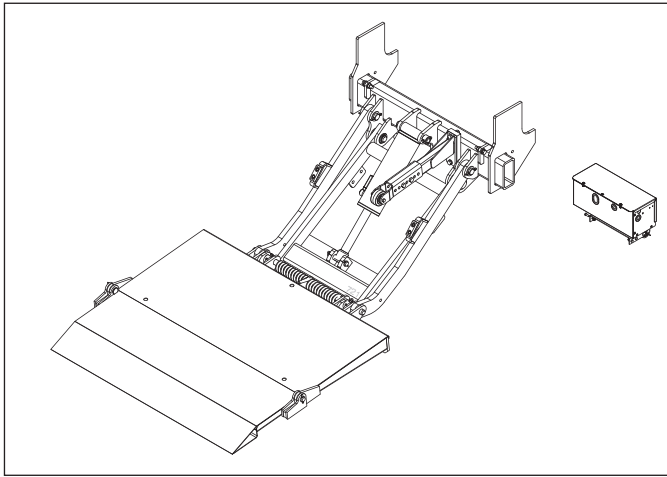

Typical Anthony Liftgates Side Mount Tuckunder Model.

## **WARNING**



### **Read, Understand, and Follow Instructions**

To avoid personal injury or death, carefully read and understand all instructions pertaining to this Anthony Liftgate. Do not attempt to operate this product without fully understanding all of the instructions and safety recommendations.

Do not operate a truck or the liftgate unless you read and understand the instructions and warnings in this Operation Manual and other related manuals for the truck.

If any doubt or question arises about the correct or safe method of performing anything found in this manual, contact your Anthony Liftgates' dealer. Proper care is your responsibility.

## **WARNING**



### **Crush Hazard**

Unsecured loads, when moved on the liftgate, can shift or fall. To prevent personal injury or death, make sure loads are securely fastened to the liftgate or restrained by cart stops, a retention ramp, or fencing.

## **SAFETY INSTRUCTIONS**

All users of this liftgate must be at least 18 years old and have read and understood all operation instructions and safety decals before use.

### 1.2 Registration

To register your liftgate go to [www.anthonyliftgates.com](http://www.anthonyliftgates.com).

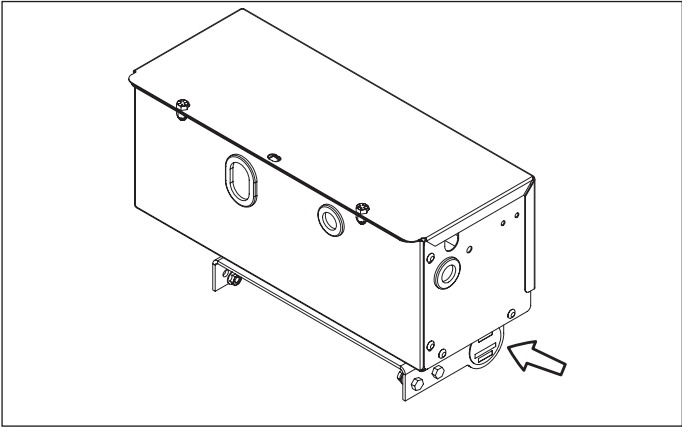

Before calling with questions or other product information requests, have the serial number, model number, and lift capacity of the liftgate available. This information is stamped into the identification plate on the side of the power unit.

Record the serial number, model number, date of installation, and load capacity for easy reference when contacting your authorized dealer with questions.

Serial Number Information	
Serial No.	
Model No.	
Date of Installation	
Lift Capacity	

### 1.3 Customer Service and Parts

For service or ordering replacement parts, contact an authorized dealer by going to [www.anthonyliftgates.com](http://www.anthonyliftgates.com) and selecting the FIND A DEALER tab. Enter your zip code to find the nearest authorized service location.

### 1.4 Safety Signs (Decals)



To prevent personal injury from not being aware of safety recommendations, make sure all decals are attached to the liftgate and/or truck and are legible at all times!

Safety signs (decals) provide a vital role in helping reduce injury and/or death. To ensure the greatest level of safety, all decals must be attached to the liftgate and be legible at all times. Remember, it is the users' responsibility to maintain these decals. For decal placement, or a complete part number list and illustration of the decals used on the tuckunder liftgate, refer to "5. Replacement Safety Signs (Decals)" on page 13 in this manual.

## 1.5 Warranty

For a detailed copy of the Warranty Statement, refer to "7. Warranty Section" on page 25.

1. Unauthorized modifications or use of the liftgate may cause it to improperly operate or cause other unforeseen problems or dangers. If any deviation is deemed necessary, written permission must first be obtained from Anthony Liftgates.
2. All decals must be attached and legible or all warranties are void.

## 2. Safety Section

---

### 2.1 Safety is Your Responsibility



It is the responsibility of the user to understand and properly use this liftgate. Be aware of the inherent dangers in the use of this product.

Read and understand all Warnings, Cautions, Notices, and Safety Instructions in this manual, on the liftgate, or on the truck.

Accidents can often be avoided by being alert and recognizing potentially hazardous situations. Anyone operating the liftgate must have the necessary training, skills, and tools required to perform these functions properly and safely. The safety information in this manual serves as a basic guide in an attempt to prevent injury or even death.

Anthony Liftgates cannot anticipate every possible circumstance that might involve a potential hazard. The identification of hazardous situations in this manual and on the product itself are, therefore, not all-inclusive. If procedures, work methods, or operating techniques that are not specifically mentioned by Anthony Liftgates are used, you must satisfy yourself that they are safe for you and for bystanders. Make sure the liftgate or truck it is mounted onto will not be damaged or made unsafe by any operating method you choose.

DO NOT proceed if any doubt arises about the correct or safe method of performing anything found in this or other related equipment manuals. If in doubt, seek out expert assistance from a qualified person before continuing.

## 2.2 Safety Signal Words



Personal injury hazards are identified by the “Safety Alert Symbol” and followed by a signal word such as **WARNING** or **CAUTION** to indicate the severity of the hazard.



This safety alert icon surrounds an image showing a specific type of injury which should be avoided.



**WARNING**

Indicates a potentially hazardous situation which, if not avoided, **COULD** result in death or serious injury.



**CAUTION**

Indicates a potentially hazardous situation which, if not avoided, **MAY** result in minor or moderate injury.

**NOTICE**

*Indicates that equipment or property damage can result if instructions are not followed.*

**SAFETY  
INSTRUCTIONS**

Indicates specific safety-related instructions or procedures.

**Note:** Contains additional information important to a procedure.

## 3. Operation Section

### 3.1 General Operating Safety Instructions



**WARNING**



Do not use this liftgate for any other purpose than its intended use of loading and unloading cargo from the bed of a truck.



Do not overload the platform. The maximum rated capacity is based on an evenly distributed load on the platform's flat surface.



#### **Crush Hazard**

- Do not stand in the platform's work area while operating the liftgate. Serious injury or death could result if the load shifts, falls, or is unstable on the platform.
- Do not go under the liftgate while it is in a raised position. Accidental lowering could cause serious crushing injuries.
- Do not stand under or place any object under the liftgate work area.



To prevent personal injury, immediately clean up any spilled fluid on the liftgate platform. To avoid tripping, do not leave anything lying on the platform or around the

work area.



Do not allow children to play on/around or operate the liftgate.





Anthony Liftgates recommends not riding the liftgate; however, if the operation requires it, make sure your footing is stable before raising or lowering the platform. Always stand away from the edge. When on the ground, always stand clear of the liftgate when it is operating.



Always use/set the truck's parking brake and remove the ignition key before operating the liftgate. Failure to follow this recommendation can result in injury.



Do not place hands or feet in pinch points, between the platform and the platform extension, or under the edge of the liftgate.

## SAFETY INSTRUCTIONS



Do not allow the liftgate to be used by persons unfamiliar with its operation.



Visually inspect the liftgate before use to make sure all parts are in good working condition and operates freely. Have any damaged parts replaced immediately.



To prevent possible injuries due to improper operation, make sure all decals are attached to the liftgate and/or truck and are legible at all times.



Always use three points of contact during ingress or egress of the truck or platform.



Make sure the area in which the platform will open and close is clear before opening, closing, raising, or lowering the platform.



Always place the load as close to the center of the platform as possible and as close to the truck as possible.



Only operate the liftgate with the switch controls mounted on the truck body unless an optional hand-held remote is installed.



Do not operate lift trucks on or over any part of the platform.



### 3.2 Operating Instructions

Many liftgates are installed with a cut-off solenoid or a cut-off switch to prevent accidental or unauthorized use of the liftgate by disconnecting power from the battery to the power unit. If not installed, Anthony Liftgates strongly recommends the installation of one of these devices.

1. Raise and slide the latch pin toward the curbside of the liftgate.

#### **NOTICE**

*Do not force the pin to open. In some cases, the liftgate can settle down against the pin causing it to bind or be very difficult to slide. If the pin does not slide easily, slightly raise the liftgate to relieve pressure on the latch pin.*

2. Press and hold the control switch in the DOWN position until the folded platform rests on ground.
3. Manually unfold main platform.
4. Manually unfold flipover section.
5. Raise and lower platform using UP and DOWN functions of control switch.

#### **SAFETY INSTRUCTIONS**

**Do not bounce the platform by pushing and releasing the control switch abruptly.**

#### **NOTICE**

*Do not allow the motor/pump to run after the liftgate is closed, or in the up position.*

6. Reverse steps to fold and store platform. Make sure platform is locked in storage position with latch pin after use.

#### **SAFETY INSTRUCTIONS**

**When placing the liftgate in the storage position (folding), slowly fold the platform until it contacts the wheel arm assembly. Lock the liftgate into the storage position with the latch pin whenever the liftgate is not in use.**

## ANTHONY TUCKUNDER LIFTGATES OPERATING INSTRUCTIONS

1. Raise (twist) latch pin handle upwards and then slide pin sideways to release.

Do not force the latch. Liftgate may need to be slightly raised or lowered to release pressure on latch pin.

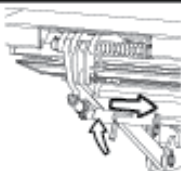

2. Press control switch DOWN until folded platform rests on ground.

Always stand on curbside of truck when raising or lowering platform with control switch.

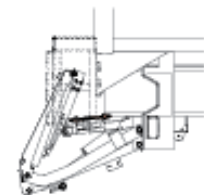
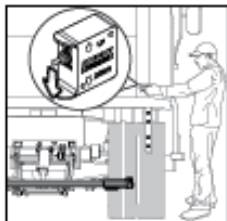

3. Manually unfold main platform.

Always stand on curbside of truck when unfolding platform.

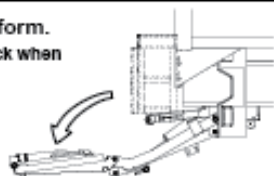

4. Manually unfold flipover section.

Always stand on curbside of truck when unfolding flipover section.

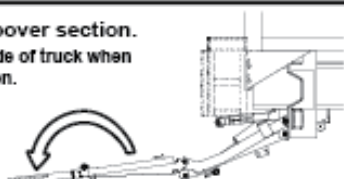

5. Raise and lower platform using UP and DOWN functions of control switch.

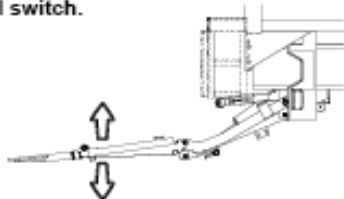

6. Reverse steps to fold and store platform. Make sure platform is locked in storage position with latch pin after use.

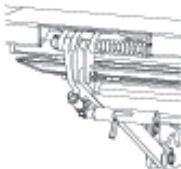

ATU-423

## 4. Routine Service Items

### 4.1 Check Power Module Fluid Level

**Power Down Models:** Check the fluid level with the platform fully raised. The oil level should be approximately 1 inch below the filler cap.

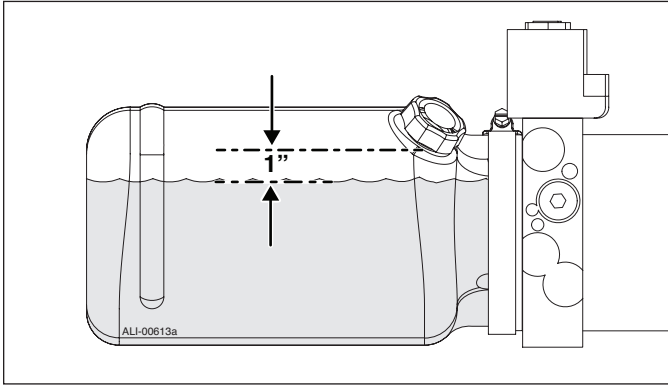

**Gravity Down Models:** Check the fluid level with the platform resting on the ground. The oil level should be a maximum of 1 inch from the top of the reservoir.

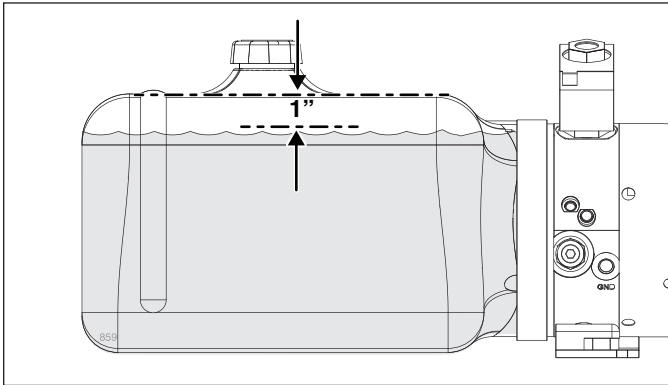

### NOTICE

*To prevent damage to the pump, use only the recommended Hyken Glacial Blu anti-wear, low-viscosity, hydraulic fluid in the power unit reservoir.*

*In an emergency, use any anti-wear hydraulic fluid, but flush the system and replace it with our recommended fluid soon as reasonably possible. Do not mix hydraulic oil and automatic transmission fluid due to possible compatibility problems.*

*Use the appropriate viscosity of fluid based on the surrounding climate conditions. Viscosity is important because the pump will not cause a temperature increase to the oil in the reservoir, like a typical closed-loop hydraulic system.*

*DO NOT use brake fluid in place of our recommended fluids.*

## 4.2 Power Cable Fuse - 200 Amp



To avoid injury or property damage, disconnect the liftgate's power cable from the battery before starting to replace the fuse. An "arc" can occur resulting in personal injury or property damage if the power cable is connected to the battery.

1. Cut the heat shrink tube to expose the fuse, mounting hardware, and lugs.
2. Remove the bolt, washer, and lock washer from each end of the fuse.
3. Use the A-133610, 200 Hi-Amp Fuse Replacement Kit for the replacement parts
4. Slide the new heat shrink tube over one side of the wiring.
5. Bolt the new fuse to the cable lugs using the bolts, washers, and lock washer, as shown.

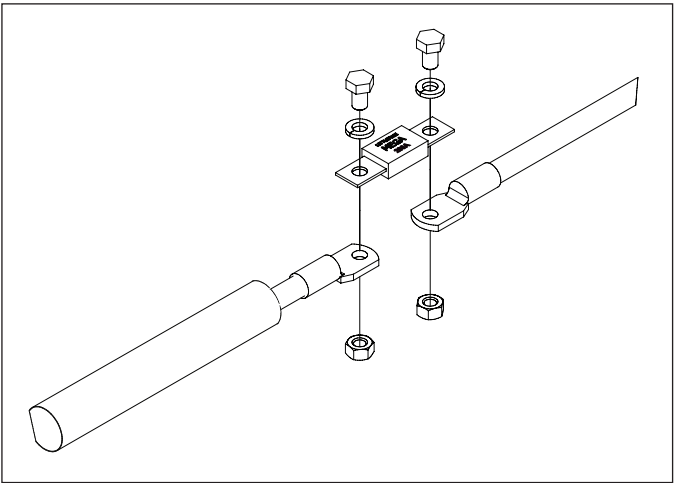

6. Slide the heat shrink tube over the fuse, hardware, and lugs. Using a heat gun apply heat evenly to shrink the tubing.
7. Reconnect the power cable to the battery after you are certain liftgate area is clear.

**Note:** If the fuse continues to blow, contact your authorized dealer.

### 4.3 Control Switch Fuse - 10 Amp

If the control switch is not operating the liftgate, check the in-line fuse located on the control cable inside the power unit box.

Replace with A-150438 10A Fuse.

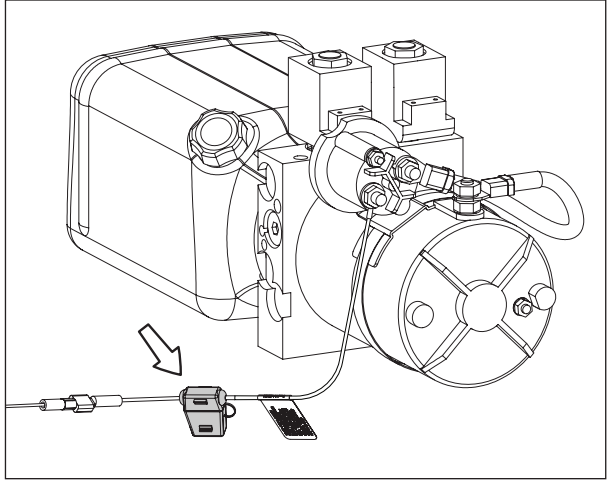

## 5. Replacement Safety Signs (Decals)

### 5.1 Placement of Decals

#### **SAFETY INSTRUCTIONS**



To prevent possible injuries due to improper operation, make sure all safety signs (decals) are properly placed and attached to the liftgate and/or truck and are legible at all times.

Safety signs or decals provide a vital role in helping to reduce injuries and/or death. To ensure the greatest level of safety, all decals must be properly placed and legible at all times. Remember, it is the users' responsibility to maintain these decals.

For replacement decals contact an authorized dealer by going to **[www.anthonyliftgates.com](http://www.anthonyliftgates.com)** and selecting the FIND A DEALER tab. Enter your zip code to find the nearest authorized service location.

1. Attach decals 1 through 5 to the truck body, as shown.

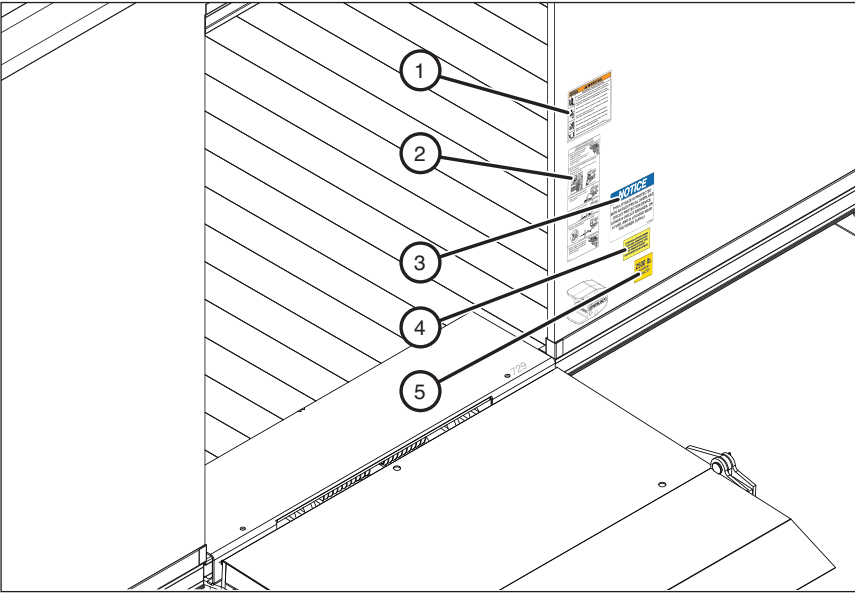



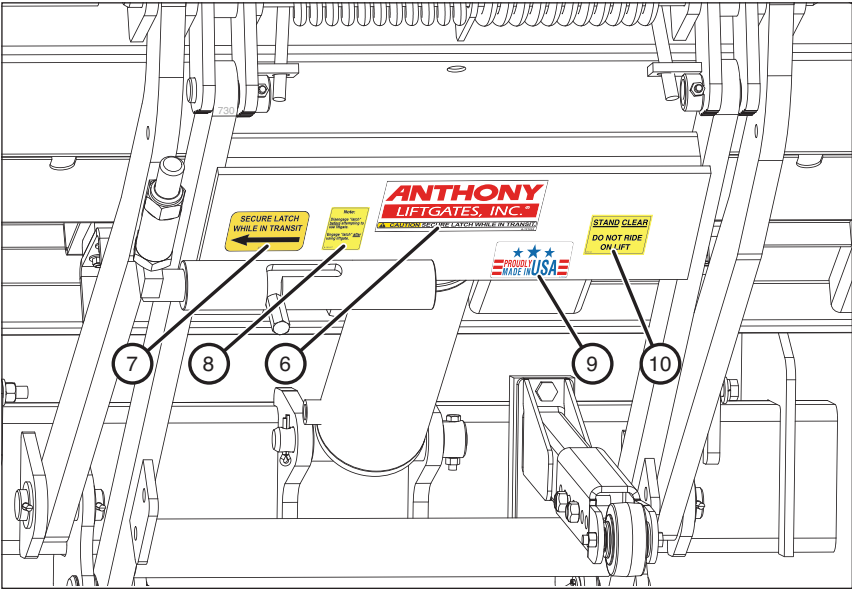

2. Make sure factory-installed decals 6 through 10 are attached to the lift arms and platform.

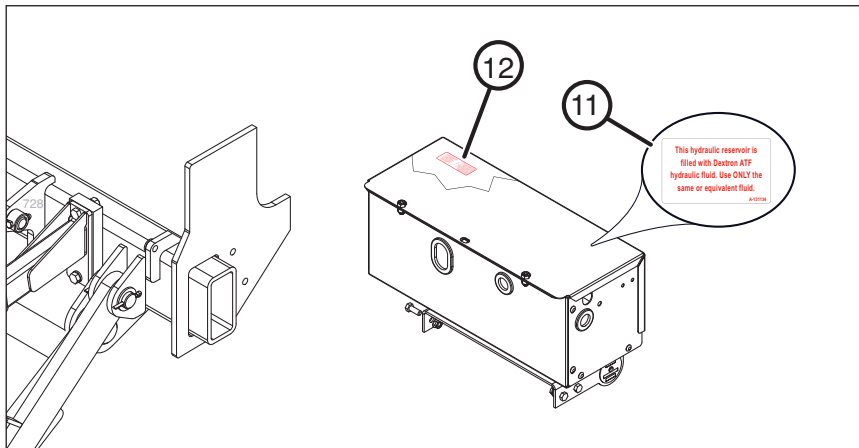

3. Make sure factory-installed decals 11 through 12 are installed on the power unit.





<b>ANTHONY</b> LIFTGATES, INC.®		<b>⚠ WARNING</b>	
		<b>PERSONAL INJURY HAZARD</b>	
	<b>Operation may require user to stand on platform. To prevent injury or death of operators or bystanders:</b>		
	<ul style="list-style-type: none"><li>• Read and follow operator/owner manual for safety, operation, inspection, and maintenance instructions.</li></ul>		
	<ul style="list-style-type: none"><li>• Do not place unstable or unsafe loads on platform.</li><li>• Do not allow loads to extend over edge of platform.</li></ul>		
	<ul style="list-style-type: none"><li>• Do not exceed capacity or use liftgate for anything other than intended purpose.</li><li>• Be aware of surroundings when operating liftgate.</li><li>• Do not allow body parts to contact moving components.</li></ul>		
	<ul style="list-style-type: none"><li>• Ensure footing is stable and stand away from edge before raising or lowering platform.</li><li>• Owner/operators must properly maintain liftgate.</li></ul>		
		A-131115	

**ADVERTENCIA**  
**PELIGRO DE LESIÓN PERSONAL**

La operación puede requerir que el usuario se pare sobre una plataforma. Para evitar lesiones o la muerte de operadores o transeúntes:

- Lea y siga las instrucciones del manual del operador o del propietario en cuanto a seguridad, operación, inspección y mantenimiento.
- No coloque cargas inestables o poco seguras sobre la plataforma.
- No permita que las cargas sobresalgan por el borde de la plataforma.
- No supere la capacidad máxima ni utilice el montacargas para ninguna otra cosa que no sea el propósito previsto.
- Preste atención a los alrededores cuando utilice el montacargas.
- Tenga cuidado de que ninguna parte del cuerpo esté en contacto con los componentes que están en movimiento.
- Asegúrese de estar sobre una superficie estable y aléjese de los bordes mientras la plataforma está subiendo o bajando.
- El debido mantenimiento del montacargas corre por cuenta del propietario o los operadores.

# ANTHONY TUCKUNDER LIFTGATES OPERATING INSTRUCTIONS

1. Raise (twist) latch pin handle upwards and then slide pin sideways to release.  
Do not force the latch. Liftgate may need to be slightly raised or lowered to release pressure on latch pin.

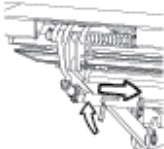

2. Press control switch DOWN until folded platform rests on ground.  
Always stand on curbside of truck when raising or lowering platform with control switch.

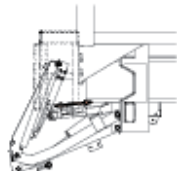
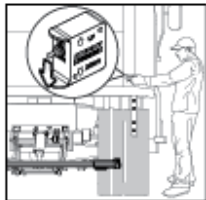

3. Manually unfold main platform.  
Always stand on curbside of truck when unfolding platform.

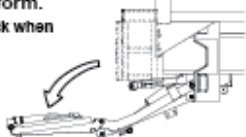

4. Manually unfold flipover section.  
Always stand on curbside of truck when unfolding flipover section.

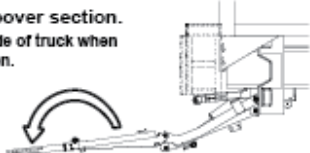

5. Raise and lower platform using UP and DOWN functions of control switch.

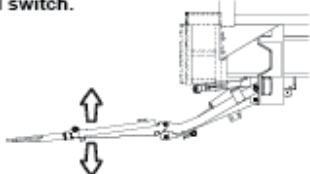

6. Reverse steps to fold and store platform. Make sure platform is locked in storage position with latch pin after use.

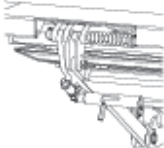

ATU-425

# INSTRUCCIONES DE MANEJO

1. Levante (gire) la manija del pasador del pestillo hacia arriba y luego deslice el pasador hacia un lado para liberarlo.

No fuerce el pestillo. Es posible que la compuerta levadiza deba elevarse o bajarse ligeramente para liberar presión sobre el pasador de seguridad.

2. Presione el interruptor de control hacia ABAJO hasta que la plataforma plegada descanse en el suelo.

Párese siempre del lado de la acera del camión cuando suba o baje la plataforma con el interruptor de control.

3. Abrir manualmente la plataforma principal.

Párese siempre del lado de la acera del camión cuando abra la plataforma.

4. Abrir manualmente la sección flipover.

Párese siempre del lado de la acera del camión cuando despliegue la sección de flipover.

5. Suba y baje la plataforma utilizando las funciones ARRIBA y ABAJO del interruptor de control.

6. Invierta los pasos para plegar y almacenar la plataforma. Asegúrese de que la plataforma esté bloqueada en la posición de almacenamiento con el pasador de seguridad después de su uso.

## **NOTICE**

**THIS LIFTGATE IS PROTECTED WITH AN ELECTRICAL OVERLOAD CIRCUIT PROTECTION DEVICE, EITHER A CIRCUIT BREAKER, OR A FUSE, AND IS LOCATED NEAR THE POWER SUPPLY**

A-150238

## **AVISO**

**ESTE MONTACARGAS CUENTA CON UN DISPOSITIVO QUE PROTEGE EL CIRCUITO CONTRA LAS SOBRECARGAS ELÉCTRICAS, YA SEA UN DISYUNTOR O UN FUSIL, UBICADO CERCA DE LA FUENTE DE ALIMENTACIÓN.**

**AFTER USING LIFTGATE, SECURE LATCH AND, IF EQUIPPED WITH POWER CUT OFF SWITCH, TURN OFF POWER TO PREVENT UNAUTHORIZED USE OF LIFTGATE.**

ATU-141

**DESPUÉS DE UTILIZAR EL PANEL POSTERIOR, FIGE EL PASADOR, Y SI ESTÁ PROVISTO DE UN INTERRUPTOR DE CIERRE DE ALIMENTACIÓN, APAGUE LA POTENCIA PARA EVITAR EL USO NO AUTORIZADO DEL PANEL POSTERIOR**

5 — ATU-175, ATU-174, ATU-147



**CAPACIDAD MÁXIMA**



**Do not overload the platform with more than the specified weight.**

**No sobrecargue la plataforma con más del peso especificado.**

6 — A-131034



**PRECAUCIÓN  
BLOQUEE EL SEGURO MIENTRAS ESTÉ EN TRÁNSITO**

7 — ATU-143



Bloquear el pestillo en tránsito

8 — A-131017



Nota:

Desenganche el  
“pasador” antes de  
intentar utilizar el panel  
posterior.

Enganche el “pasador”  
después de utilizar el  
panel posterior.

9 — A-150601





**MANTENTE ALEJADO**  
**DE**

SIN JINETES

11 — A-131133

**This hydraulic reservoir is filled with Kendall Glacial Blu hydraulic fluid. Use ONLY the same or equivalent fluid.**

**A-131133**

**El depósito hidráulico está lleno con líquido hidráulico Kendall Glacial Blu. Use ÚNICAMENTE el mismo líquido o uno equivalente.**

12 — A-131001 (attached to control cable)

**10 AMP FUSE & HOLDER**  
Protects against dead shorts in this "control circuit".  
If blown, pull "fuse holder cap", replace fuse, replace "cap". If fuse continues to blow, contact a qualified mechanic, "control circuit" may be damaged.

**A-131001**

**10 AMP FUSE & HOLDER**  
Protects against dead shorts in this "control circuit".  
If blown, pull "fuse holder cap", replace fuse, replace "cap". If fuse continues to blow, contact a qualified mechanic, "control circuit" may be damaged.

**FUSIBLE DE 10 AMPERIOS Y SOPORTE - Protege contra cortocircuitos francos en este "circuito de control". Si el fusible se quemó, quite la "tapa del soporte del fusible", cambie el fusible y vuelva a colocar la "tapa". Si el fusible continúa quemándose, comuníquese con un mecánico calificado, dado que el "circuito de control" podría estar dañado.**

## 6. Troubleshooting

Troubleshooting Chart	
<b>Motor does not run when control switch is activated.</b>	
<sup>1</sup> (If the problem cannot be quickly and easily resolved by the operator, the liftgate should be taken to an authorized dealer for repair).	
Possible Causes	Possible Solution
If installed, cab cut-off switch is OFF.	Place switch to ON position. Note <sup>1</sup>
If installed, power cut-off solenoid is switched OFF or is defective.	Place switch to ON position. Note <sup>1</sup>
Truck battery is dead.	Check for loose or corroded battery connections and make sure battery is fully charged. Replace or recharge battery.
In-line 200 Amp circuit protection fuse in main wiring cable from truck battery is blown.	Replace fuse with A-133610, 200 Hi-Amp Fuse. Note <sup>1</sup> Refer to "4.2 Power Cable Fuse - 200 Amp" on page 12.
10 Amp fuse for control box switch in power unit box is blown.	Replace fuse with A-150438 10A Fuse.. Note <sup>1</sup> Refer to "4.3 Control Switch Fuse - 10 Amp" on page 13.
Motor start solenoid is bad.	Note <sup>1</sup>
Battery cable is damaged.	Note <sup>1</sup>
Motor is not working.	Note <sup>1</sup>
<b>Motor runs, but liftgate will not open or lower to the ground.</b>	
Latch pin is closed (in transport position).	Slide the latch pin to the open position.
Low oil level in reservoir.	Add oil to the appropriate fill level. Refer to "4.1 Check Power Module Fluid Level" on page 11.
Other causes which are not able to be fixed by operator: Structural damage. Lowering valve solenoid on pump. Lowering valve cartridge on pump. Flow control valve on cylinder.	Note <sup>1</sup>
<b>Motor runs, but platform will not raise, will not raise rated capacity, or raises but drifts down when control switch is released.</b>	
Load capacity has been exceeded.	Verify load capacity and adjust load weight.
Low fluid level.	Add oil to the appropriate fill level. Refer to "4.1 Check Power Module Fluid Level" on page 11.



Troubleshooting Chart	
<b>Motor runs, but . . . (continued)</b>	
Low Voltage.	Make sure truck battery is fully charged.
Other causes which are not able to be fixed by operator: Structural damage. Lowering valve solenoid on pump. Lowering valve cartridge on pump. Defective piston seals. Defective piston pump. Flow control valve on cylinder.	Note <sup>1</sup>
<b>Latch pin is broken or bent.</b>	
Platform has been lowered without releasing latch pin.	The latch pin is only used to prevent the liftgate from opening due to a pressure leak or pressure bleed-off over an extended period of time. Always release latch before opening liftgate.
<b>Liftgate raises truck when lowered to the ground.</b> <sup>1</sup> (If the problem cannot be quickly and easily resolved by the operator, the liftgate should be taken to an authorized dealer for repair).	
Power down system pressure is set too high.	Note <sup>1</sup>
<b>Liftgate will not open.</b>	
Platform operating area is not clear.	Clear platform operating area.
Latch pin will not slide freely to release liftgate.	Activate the "UP" switch and slightly raise the liftgate to the fully stored position. The latch pin should slide freely.
<b>Platform lowers extremely slow.</b>	
Low oil level on power down models.	Add oil to the appropriate fill level. Refer to "4.1 Check Power Module Fluid Level" on page 11.
Other causes which are not able to be fixed by operator: Structural damage. Improper oil in hydraulic reservoir. Lift arm bushings are worn. Damaged or kinked hydraulic hose. Cylinder rod is scored, pitted, or bent. Faulty flow control valve in cylinder. Faulty lowering valve on pump.	Note <sup>1</sup>

Troubleshooting Chart	
<b>Platform raises partially and stops.</b>	
Load capacity has been exceeded.	Reduce weight of load.
Low Voltage.	Make sure battery is fully charged.
Low pressure.	Add oil to the appropriate fill level. Refer to "4.1 Check Power Module Fluid Level" on page 11.
Structural damage.	Replace damaged parts.
<b>Platform will not lower.</b>	
<sup>1</sup> (If the problem cannot be quickly and easily resolved by the operator, the liftgate should be taken to an authorized dealer for repair).	
Platform operating area is not clear.	Clear working area.
Low Voltage.	Make sure battery is fully charged
Structural damage.	Note <sup>1</sup>
Lowering valve.	Note <sup>1</sup>
Hydraulic pump and motor.	Note <sup>1</sup>

## 7. Warranty Section

---

### 7.1 Limited Warranty

#### **Magnum Tuckunder**

#### **3 yrs Mechanical + 3 yrs Electric/Hydraulic**

Thank you for purchasing an Anthony liftgate. We strive to produce the most trouble free and reliable liftgates in the market. We believe you will experience years of reliable operation and minimum downtime interruptions. To further ensure your confidence in Anthony, this warranty will cover your unit for 3 years or 8,000 cycles (whichever occurs first) on mechanical/structure, electrical, and hydraulic operating parts. This warranty is extended to the original purchaser (user only) and is not transferable. The warranty term begins from the date of shipment from our factory or warehouse.

Anthony Liftgates Inc. will cover all failed components during the warranty period. Labor will be provided under our Flat Rate Warranty Schedule, in effect at the time of the part failure, and includes diagnosis time. Contact Anthony for current reimbursement amounts. For repairs NOT listed on the Flat Rate Warranty Schedule, contact the Anthony Warranty Department for approved reimbursement, prior to performing repairs. Anthony Liftgates Inc. reserves the right of determination of whether a component is defective or has failed. This warranty applies to Anthony liftgates installed, operated, and maintained in accordance with Anthony Liftgates Inc. installation, operation, and maintenance manuals, videos, etc.

Certain Anthony models have published Lifetime Warranties on listed components, as published in current literature. This additional coverage will be detailed on the published operation components, providing the unit has been operated and maintained within the intended usage.

Anthony Liftgates, Inc. will process all claims and determine their eligibility for authorization upon the receipt of the failed part, the identification of the claimant, and the liftgate serial number. All parts must be returned freight prepaid and following the instructions given by the Anthony Warranty Department. Freight collect shipments will not be accepted.

**PLEASE NOTE THAT NO CLAIMS WILL BE PROCESSED WITHOUT THE PART, THE CLAIMANT'S INFORMATION, AND THE LIFTGATE SERIAL NUMBER.**

Claims not submitted within 30 days of repair date will be denied.

**NOTE: ALL CLAIMS MUST BE COMPLETED ON THE ANTHONY LIFTGATES INC. WARRANTY CLAIM FORM.**

This form provides all the necessary information.

Upon approval of the claim, Anthony will, at the direction of the claimant, return a replacement part and labor allowance, or a parts credit based on current distributor net pricing, and the appropriate flat rate labor allowance.

Anthony Liftgates, Inc. is not responsible or liable for loss of time, cost, labor, material, profits, direct or indirect damages caused by failed components, whether due to rights arising under purchase, order, contract of sale or independently thereof, and whether or not such claim is based on contract, tort, or warranty. The sale of products of Anthony Liftgates, Inc. under any other warranty or guarantee express or implied is not authorized. This warranty does not cover misuse, abuse, damage, or product finish, normal wear, maintenance adjustments, careless or negligence of use or maintenance. Modifications to our product are not covered unless prior authorized by Anthony.

Purchased Parts warranty is 1 year from date of purchase and covers replacement of part only.

If you require assistance or have questions, please contact Anthony Liftgates Inc. at 815-842-3383.

**Note:** *Most (not all) Anthony liftgate models incorporate our Service-Free feature. Service-Free refers to the fact that these models require no routine or scheduled lubrication of the major pivot points that contain our service-free bushings. Normal repair and maintenance of your liftgate, per our instruction, is necessary for ALL Anthony liftgates.*

Anthony Liftgates, Inc.  
1037 W. Howard St. P.O. Box 615  
Pontiac, IL 61764-0615

PH: 815-842-3383  
FAX: 815-844-3612  
E-Mail: [warrantyclaims@anthonyliftgates.com](mailto:warrantyclaims@anthonyliftgates.com)

## 7.2 Warranty Policy and Procedure

All warranty claims must be completed on the Anthony Liftgates Warranty Claim Form utilizing the Flat Rate Warranty Schedule. See the current rates as listed for each model. Using this process will allow for quick and accurate credit payment.

Claims will not be processed without the failed part returned (pre-paid) to Anthony Liftgates, and the warranty claim form completed.

**NOTE:** When returning defective parts for warranty consideration, be sure to call ahead for a Return Authorization Number.

If you require further assistance or have questions, please contact the Anthony Liftgates Warranty Dept. at 815-842-3383 or email [warrantyclaims@anthonyliftgates.com](mailto:warrantyclaims@anthonyliftgates.com).



# ANTHONY

LIFTGATES, INC.®

ING LIFTGATE, SECURE  
ED, IF EQUIPPED WITH  
OT UP SWITCH, TURN  
POWER TO PREVENT  
UNSAFE USE OF LIFTGATE.

500 lb.  
MAXIMUM  
CAPACITY



THE ORIGINAL NAME IN LIFTGATES - SINCE 1941

**ANTHONY**  
LIFTGATES, INC.®

**SM**

1037 WEST HOWARD ST.  
P.O. BOX 615  
PONTIAC, IL 61764-0615  
PH: 815-842-3383  
FAX: 815-844-3612  
TOLL FREE: 800-482-0003  
[WWW.ANTHONYLIFTGATES.COM](http://WWW.ANTHONYLIFTGATES.COM)